

MOTORLAGER TM2 35

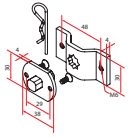

A3506_0552
Lager TK 60, mit 10 mm Innenvierkant

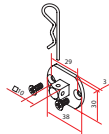

A3506_0555
Vierkant 10 mm für TM35



A3506_0554
Motorkopfadapter 35 mm-45 mm

MOTORLAGER TM2 45

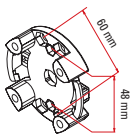

132300
Universallager TK48 u. 60 Vorbau bis 30 Nm

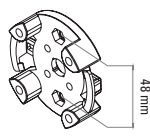

132303
Universallager TK48 verstärkt 50 Nm

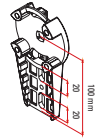

132306
Neubaukastenlager bis 30 Nm

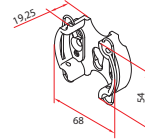

A4506_0555
Schnellanschluss-Motorlager

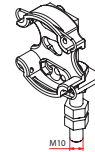

A4506_0570
Motorlager regulierbar

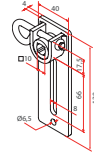

A4506_0562
Abrollager Vierkant für Neubaukastenlager (mit lösbarer Nabe)



132345
Universallager für Heroal-BK-Systeme

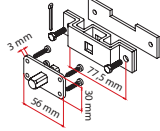

132325
Renovierungslager Vierkant 10 x 10 mm

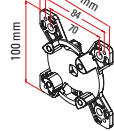

132324
Universallager 100 x 100 mm bis 30 Nm

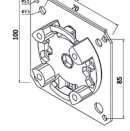

132323
Universallager auf Platte 100 x 100 mm bis 30 Nm (Kömmerling)

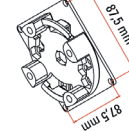

132329
BK-Lager bis 30 Nm

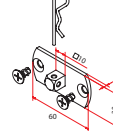

A4506_0569
Vierkantstift 10 mm

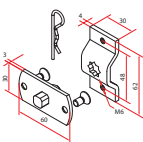

A4506_0567
Motorlager mit Omegaplatte -VK 10 mm

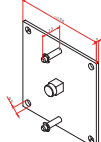

A4506_0632
Lagerplatte 100 x 100 mit Aufsteckbolzen für NHK-Antriebe

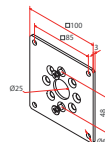

A4506_0568
Motorlagerplatte 100 x 100

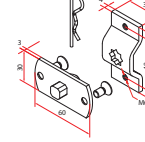

A4506_0557
Motorlager Omega mit Vierkantstift 10 mm mit M6 Gewinde

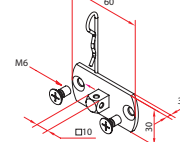

A4506_0580
Vierkant 10 mm mit Platte M6 Gewinde

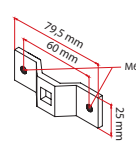

132328
Lager TK 60, mit 10 mm Innenvierkant

MOTORLAGER TM2 58

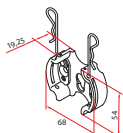

A4506_0554
Schnellanschluss-Motorlager mit elastischen Splinten

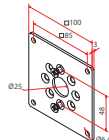

A4506_0568
Motorlagerplatte 100 x 100

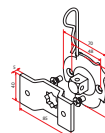

A5806_0551
Motorlager Omega mit Vierkantbolzen 16 mm

